



Zoning Permit Application

Metamora Township

730 W. Dryden Road • Metamora, MI
48455 • (810) 678-2237

Date _____

Parcel I.D. Number
44 - _____

Owner(s) Name	Applicant(s) Name
Mailing Address	Mailing Address
City, State, ZIP	City, State, ZIP
Phone	Phone

Plot Plan Required <i>A plot plan clearly indicating the following items must accompany this application:</i> - All property lines, including their dimensions - All existing and proposed buildings and/or structures, including accessory structures - All setbacks for new construction and existing buildings, including accessory structures - Location of existing and/or proposed driveways - North arrow and name of road from which the subject property has frontage or access	Project Size: Length (feet) _____ Width (feet) _____ Height (feet) _____ First Floor (Sq Ft) _____ Second Floor (Sq Ft) _____ Garage (Sq Ft) _____	
	Parcel Size: In Acres: _____ Sq. Ft.: _____ % Lot Coverage: Divide Total Sq Ft of all existing & proposed buildings by total Sq Ft of parcel = _____ % Coverage (35% max)	
Permit To: <input type="checkbox"/> Construct New <input type="checkbox"/> Alter <input type="checkbox"/> Remodel <input type="checkbox"/> Addition <input type="checkbox"/> Single Family Dwelling <input type="checkbox"/> SFO w/Attached Garage <input type="checkbox"/> Detached Garage <input type="checkbox"/> Industrial Building <input type="checkbox"/> Two-Family Dwelling <input type="checkbox"/> Multiple Family Dwelling <input type="checkbox"/> Office Building <input type="checkbox"/> Commercial Building <input type="checkbox"/> Use/Occupancy Change <input type="checkbox"/> Accessory Building (See Below) <input type="checkbox"/> Other: _____	Current Zoning _____ Flood Plain Advisory <input type="checkbox"/> Yes <input type="checkbox"/> No Wetland Advisory Soil/Sed. Advisory <input type="checkbox"/> Yes <input type="checkbox"/> No <input type="checkbox"/> Yes <input type="checkbox"/> No	
Is any aspect of this property non-conforming? <input type="checkbox"/> Yes <input type="checkbox"/> No Is this property located in or near a flood plain? <input type="checkbox"/> Yes <input type="checkbox"/> No		

Job Site Address: _____ **Brief description of intended use:** _____

Within 500' lake-river-stream-drain-wetland or natural man made waterway? Yes or No

Accessory Buildings: Is there an existing dwelling on the property? Yes No

Square Footage of existing dwelling: _____ Attached Garage? Yes No

Number of existing Accessory Buildings located on the property: _____

Total Square Footage of all Accessory Buildings located on the property: _____

Corner lot yes no

Proposed Setbacks: Front Yard _____ ft. R side Yard _____ ft. L side Yard _____ ft. Rear Yard _____ ft.

I certify the foregoing statements are true, and I acknowledge that it is my responsibility to be aware and comply with all zoning requirements of Metamora Township relating to this application. I understand that it is my responsibility to be aware of any deed restrictions, subdivision regulations, flood plain regulations, and wetland regulations.

Applicant's Signature: _____ Date: _____

DO NOT WRITE BELOW THIS LINE - OFFICE USE ONLY

AMOUNT PAID \$ _____ RECEIPT # _____ PERMIT APPROVED PERMIT DENIED APPLICATION REJECTED

PERMIT APPROVED WITH THE FOLLOWING CONDITIONS:

Reason for rejection / denial:

Referred To: Planning Commission Zoning Board of Appeals Other: _____

Zoning Administrator _____ Date _____

Residential Plot Plans

Step by step instructions

STEP #1 On a 8x11 piece of paper or your survey indicate your parcel size and dimensions

STEP #2 Indicate the road/street that you live on

STEP #3 Draw all existing and proposed structures, the dimensions, or existing square footage, and the setbacks from each property line

STEP #4 Draw all natural features including ponds, creeks, timber stands, or topography greater than a 2 foot contour.

STEP #5 Draw all utility or other easements on the property

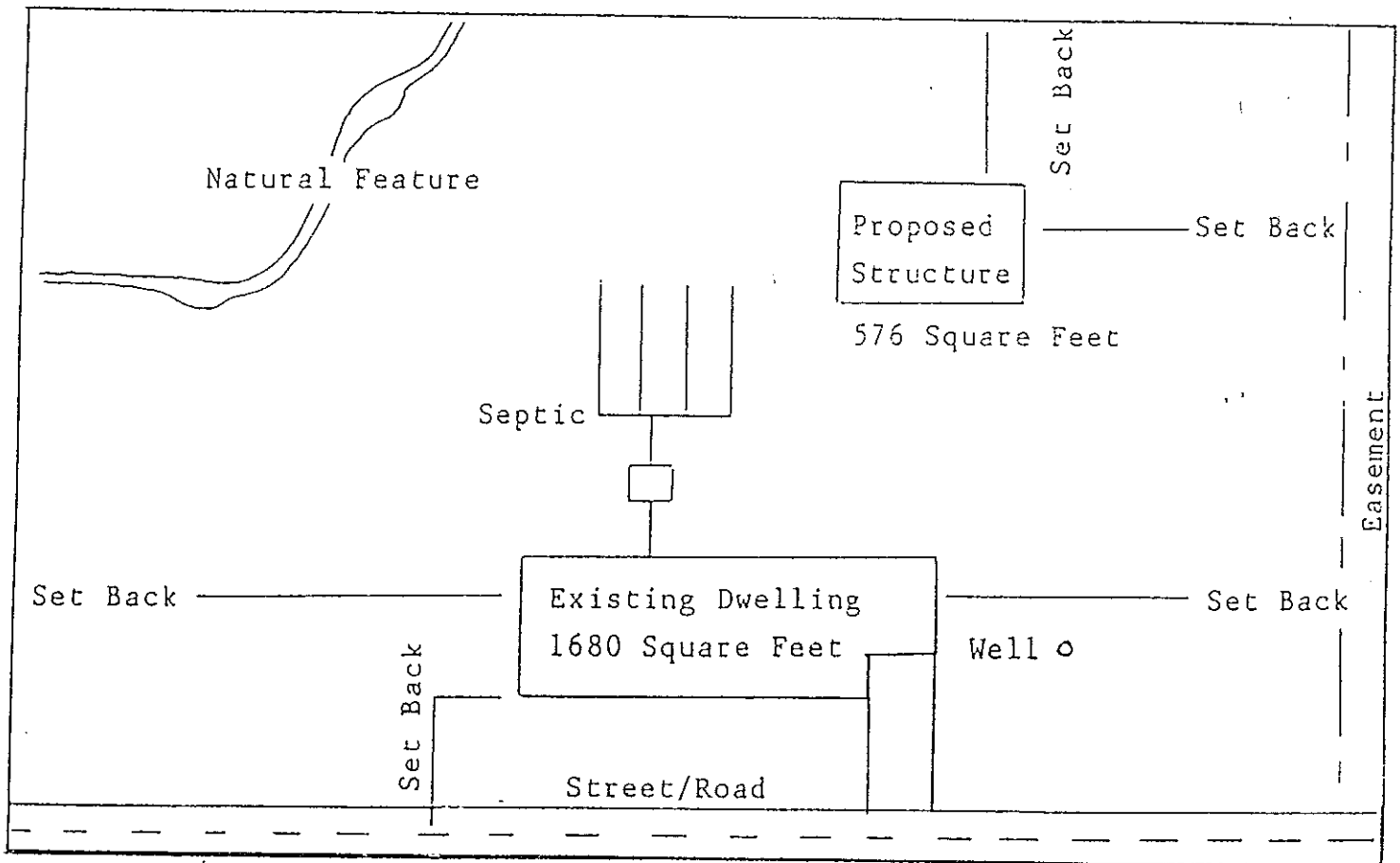

The Plot plan is required as part of your application for a Zoning Permit, No Permit will be issued unless the Plot Plan indicates all required info.